

Motorized Pulleys for belt conveyors

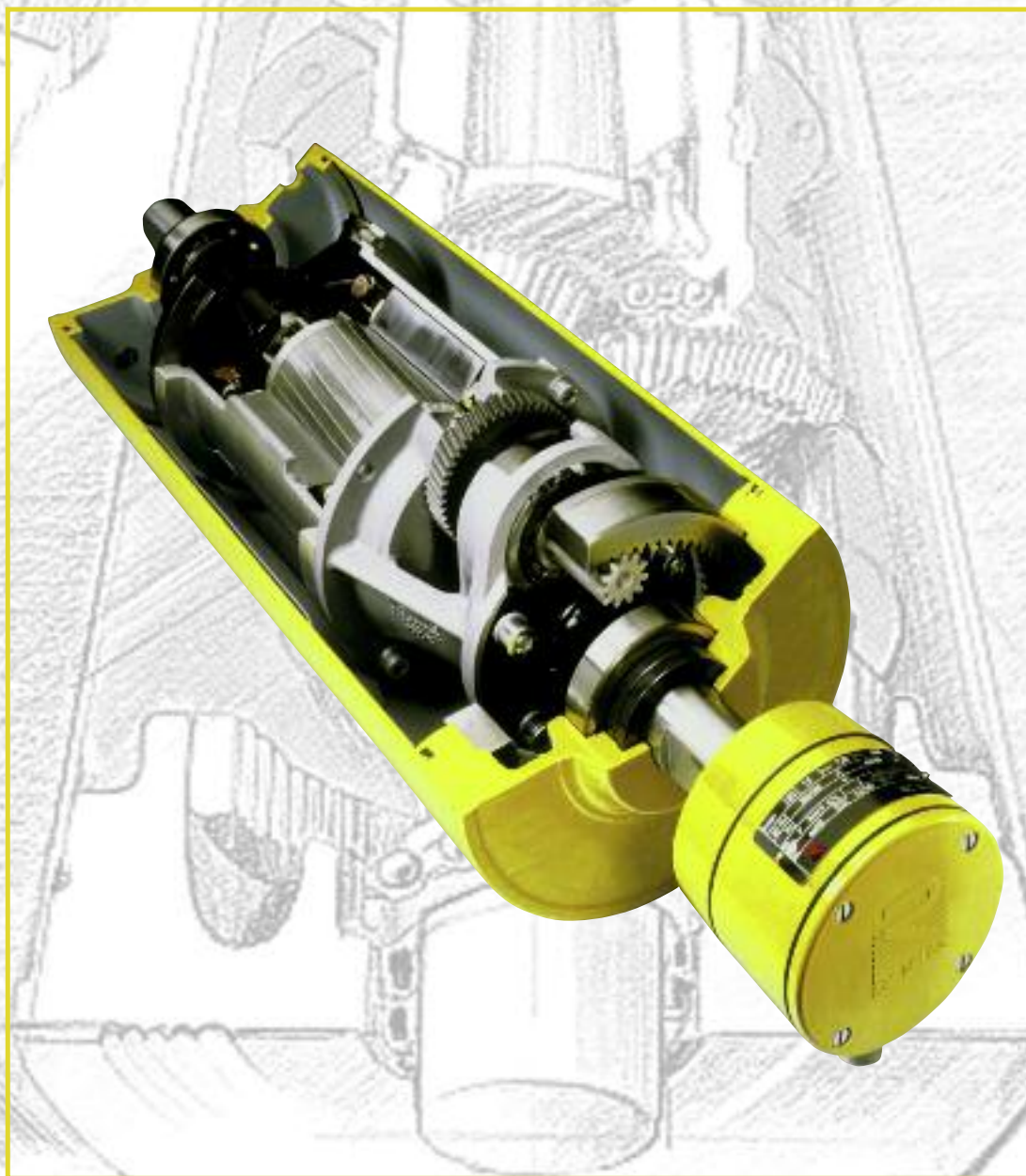

Summary table



4° ed. MOT BU RULMECA GERMANY EN 03/10

BULK HANDLING



Rulmeca Motorized Pulleys: a new name with deep roots

The Rulmeca Motorized Pulleys presented in this catalogue have a long history to tell.

It goes back to the 1950's, when the product was developed in Germany and Denmark.

Eventually, through a merging process the German Förder- und Antriebstechnik Aschersleben GmbH and the Danish John Kirkegaard Maskinfabrik A/S became partners of the Interroll Group.

From the early 1990's the manufacturing of all Interroll's BULK Motorized Pulleys were centralised in Aschersleben, Germany.

In July 2003 the production facility in Aschersleben, Germany, where Motorized Pulleys have been developed and produced for almost half a century, was purchased by Rulli Rulmeca Spa Italy, along with the entire BULK Business Unit.

It is from this plant, today renamed **RULMECA GERMANY GmbH**, that the JOKI, EGT and INTERROLL traditions for quality and reliability will be continued under the **RULMECA brand**.

It is thanks to this long history that Rulmeca can be ranked as a very experienced manufacturer of BULK Motorized Pulleys offering the world largest product range.

Stay with us !

www.rulmeca.com

Features and Benefits of Rulmeca Motorized Pulleys

Purpose-built design

The Rulmeca Motorized Pulley has been specifically designed for belt conveyors.

Totally enclosed

The motor, gearbox and bearings are totally enclosed and sealed inside a steel shell; therefore they are unlikely to fail due to harmful environmental conditions such as water, dust, grit chemicals, grease, oil, etc.

Space saving design

Because the drive unit and the bearings are mounted inside the Motorized Pulley shell, it takes up much less room than a conventional drive. No need for costly extras like chains, v-belts, couplings, bearings, support structure and special guarding.

Safety

The Rulmeca Motorized Pulley is probably one of the safest drives available because the motor is completely enclosed and the external shafts are always stationary. The only moving external parts are the Motorized Pulley shell and bearing housings.

Low purchasing and installation cost

The Rulmeca Motorized Pulley is quite often less expensive than exposed drives because it has fewer parts.

Therefore less conveyor design and parts purchasing costs. It is also much quicker and easier to install - certainly less than a quarter of the time taken to fit an exposed system.

Low maintenance cost

The end user also benefits from the Rulmeca Motorized Pulley, because it requires no maintenance other than the recommended oil change every 10,000 hours and oil seal change every 30,000 hours. In other words almost 5 years between oil changes based on an 8- hour/day working week. Synthetic oil can be specified to extend the service range up to 30,000 hours.

Efficiency

The Rulmeca Motorized Pulley usually has a much higher efficiency from electrical motor to shell (Pulley face) than conventional drives, because it has fewer frictional losses, and therefore efficiencies of up to 97% can be achieved.

Cleanliness

Because the Rulmeca Motorized Pulley is hermetically sealed it cannot contaminate any conveying materials such as food, electrical components, plastics and other materials that must be kept perfectly clean during handling.

Aesthetic appearance

If installed correctly the Rulmeca Motorized Pulley always looks good. Due to its compact size and smooth lines, quite often the Motorized Pulley is out of sight, because it is hidden within the conveyor frame.

Thermal protection

All three phase Rulmeca Motorized Pulleys are protected by our thermal protection

switch. This heat sensitive switch is built into the motor windings to protect the motor from overheating. The thermal protector must be connected to a normally closed circuit.

Weight saving and distribution

Often the Rulmeca Motorized Pulley is lighter than conventional drives and often it is possible to reduce the cost of the conveyor structure, because the weight is evenly distributed within the conveyor frame.

Variable frequency converter

All Rulmeca Motorized Pulleys with 3 phase motors are easily controlled by variable frequency converters working in the 15 Hz to 65 Hz frequency range. See Technical Precautions in the catalogue.

Fewer parts

A Rulmeca Motorized Pulley consists of the Motorized Pulley and two fixing brackets! Exposed drives can require up to eight or more separate components, most of which have to be purchased from different suppliers or custom manufactured.

Low noise

Thanks to the totally sealed enclosure and high quality gears the Rulmeca Motorized Pulley runs almost at a whisper – a very important fact in today's modern factory environments.

The Rulmeca Motorized Pulley – the ideal drive unit for conveyors **"Fit it and forget it"**.



Motorized Pulley 220M-500M

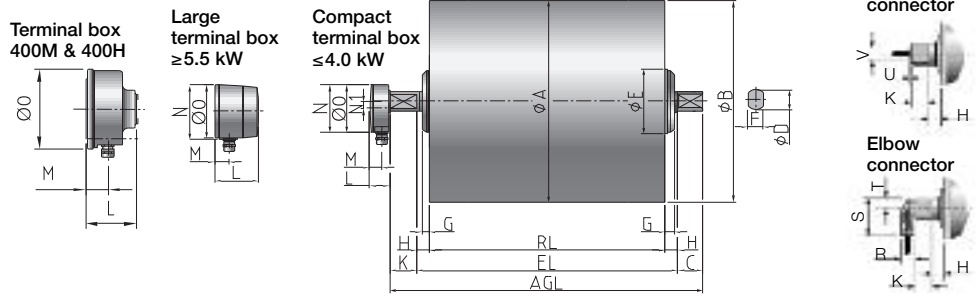

Type	Motorized pulleys or idler pulleys (UT)										Compact terminal box ≤4.0 kW				Larger terminal box ≥5.5 kW				Straight connector ≤4.0 kW		Elbow connector ≤4.0 kW		
	A	B	C	D	E	F	G	G _{TS9/11}	H	K	L	M	N	N1	L	M	N	O	U	V	R	S	T
220M & 220H	216	214.5	43.5	40	100	30	15.5	19.5	21.5	41.5	41	24	95	14	87	27	107	105	4	27	20	48	12
320L	323	319	50	40	96	30	15	19.5	25	54	41	24	95	14	-	-	-	-	4	27	20	48	12
320M	321	319	50	40	125	30	17.5	22.5	25	54	41	24	95	14	87	27	107	105	4	27	20	48	12
320H	321	319	50	50	148	40	11	20.5	25	55	41	24	95	14	87	27	107	105	4	27	20	48	12
400L	404	400	50	40	125	30	20	22.5	25	54	41	24	95	14	87	27	107	105	4	27	20	48	12
400M & 400H	404	400	50	60	194	45	23	-	25	50	-	-	-	-	100	36.5	-	156	-	-	-	-	-
500L & 500M	501	497	50	60	194	45	23	-	25	50	-	-	-	-	100	36.5	-	156	-	-	-	-	-

UT220M & UT220H	216	214.5	43.5	40	100	30	15.5	22.5	21.5	-
UT320M	321	319	50	40	125	30	14.5	22.5	25	-
UT320H	321	319	50	50	148	40	11	20.5	25	-
UT400L	404	400	50	40	125	30	17	22.5	25	-
UT400M & UT400H	404	400	50	60	168	45	20	-	25	-

Motorized Pulley 500H-800H

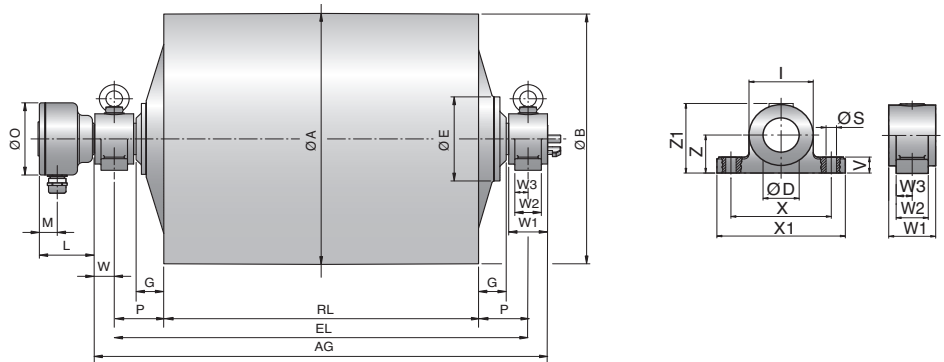

Type	Motorized pulleys or idler pulleys (UT)										S	W	W1	W2	W3	X	X1	Z	Z1
	A	B	C	D	E	G	L	M	O	P									
500H	501	497	-	65	192	95	100	36.5	156	150	23	45	90	60	-	180	240	80	141
630M	630	626	-	65	192	95	100	36.5	156	150	23	45	90	60	-	180	240	80	141
630H	630	626	-	90	268	88	165	54	230	150	26	58.5	117	80	-	250	320	100	183
800M	800	796	-	90	268	88	165	54	230	150	26	61	117	80	58.5	250	320	100	183
800H	800	796	-	120	330	80	200	62	260	150	33	95	160	120	65	300	370	110	213

UT500H	501	497	-	65	235	95	-	-	-	150	23	45	90	60	-	180	240	80	141
UT630M	630	626	-	90	226	85	-	-	-	150	26	45	117	80	58.5	250	320	100	183
UT630H	630	626	-	120	330	75	-	-	-	150	33	58.5	160	120	65	300	370	110	213

The dimension "W" is the distance between the centre of the fixing hole of the bracket to the end of the terminal box.

Mounting brackets

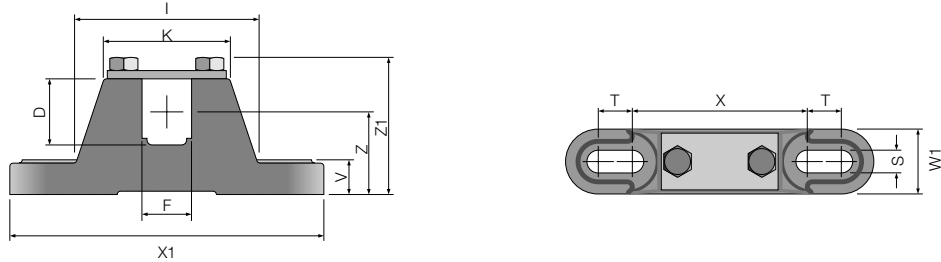

Motorized pulleys Type	Material	Bracket description	Dimension in mm													Weight in kg
			D	F	I	K	S	T	V	W1	X	X1	Z	Z1		
220M & 220H	Steel	KL41-HD	40	30	84	62	14	20	22	40	110	190	50	83	2.1	
320L & 320M	Steel	KL41-HD	40	30	84	62	14	20	22	40	110	190	50	83	2.1	
320H	Steel	KL42	50	40	121	90	18	30	25	50	150	250	70	110	4.5	
400L	Steel	KL41-HD	40	30	84	62	14	20	22	40	110	190	50	83	2.1	
400M & 400H	Steel	KL60	60	45	130	90	18	30	25	50	150	270	70	115	4.8	
500L & 500M	Steel	KL60	60	45	130	90	18	30	25	50	150	270	70	115	4.8	

Mounting brackets

Type AL - with key
& ALO - without key

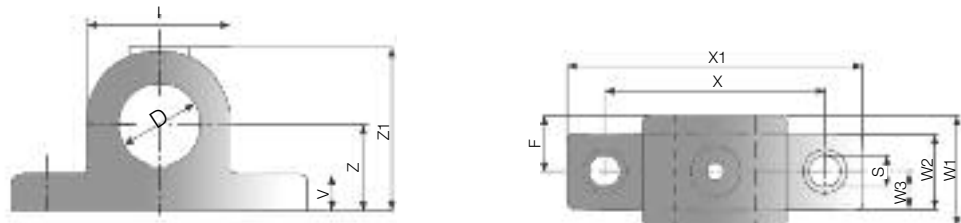

Motorized pulleys Type	Material	Bracket description	Dimension in mm												Weight in kg
			D	I	S	V	W	W1	W2	W3	X	X1	Z	Z1	
500H	Spheroidal cast iron	AL65 / AL065	65	115	23	34	45	90	60	45	180	240	80	141	8.0
630M	Spheroidal cast iron	AL65 / AL065	65	115	23	34	45	90	60	-	180	240	80	141	8.0
630H	Cast steel	AL90 / AL090	90	160	26	42	58.5	117	80	-	250	320	100	183	19.0
800M	Cast steel	AL90 / AL090	90	160	26	42	58.5	117	80	58.5	250	320	100	183	19.0
800H	Cast steel	AL120 / AL0120	120	200	33	50	95	160	120	65	300	370	110	213	38.0



New enlarged product range

Rulmeca have just launched a product range, which has been reviewed, enlarged and up-graded to meet customer requirements.

In this connection, it was necessary to re-name all product descriptions to secure an easier choice of the right pulley for the right application.

The NEW product range offers three different loading performances:

- **L for Light-duty**
- **M for Medium-duty**
- **H/HD for High-duty**

In most cases you have a choice.

Therefore, it is important to notice the differences to choose the right type of pulley for the right application based on estimated belt tension (radial load) = $T1+T2$. The actual radial load MUST be LESS than the max. allowable radial load shown in this catalogue.

Be aware of increased belt tensions using multi-ply thick heavy belts and/or larger belt widths.

If you do not find the belt tension needed in the wanted diameter, you might have to choose a larger one.

The three above loading performances offers a product range suitable for any type of application whether working under/with

- regular and constant operating conditions
- TOUGH and IRREGULAR working conditions
- irregular and extreme loadings in BRUTAL conditions.

For further information, please open our web-site - www.rulmeca.com - or contact your nearest Rulmeca distributor.

The latest **Rulmeca Motorized Pulley catalogue** (96 pages) is available on request.



Sea-dredged aggregates working in wet, salty and aggressive environment! IP66/67 sealing – a MUST – often with re-greasable seals!



Crushing & Screening. A motorized pulley in its right element!



AFRICA

SOUTH AFRICA

MELCO Conveyor Equipment
Chr. Hertzog & Jack Pienaar Street
Germiston South Ext. 7, P.O. Box 131,
1400 Germiston,
South Africa
Phone:+27 11 255 1600
Fax:+27 11 825 3592
Web:www.melcoconveyors.com
email:conveyors@melco.co.za

ASIA

CHINA

RULMECA (TIANJIN) Co. Ltd.
D1-2 & D1-4, Saida International Industrial
Park, Xiqing Economic Development
Area (XEDA)
Tianjin, People's Republic of China,
Postal Code: 300385
Phone:+86-22-2388-8628
Fax:+86-22-2388-9828
Web:www.rulmeca.com.cn
email:sales@rulmeca.com.cn

ISRAEL

Comtrans Engineering Ltd.
5 Hahoma Street
Rishon le-Zion 75655, Israel
Phone: +972 3 961 9636
Fax: +972 3 961 9644
E-mail: comtrans@comtrans.co.il

JAPAN

INTERROLL (JAPAN) Co. Ltd.
302-1 Shimokuzawa
Sagamihara-shi Kanagawa, Japan (229-1134)
Phone:+81 42 764 2677
Fax: +81 42 764 2678
email: jpn-sales@interroll.com

KAZAKHSTAN

RULMECA GERMANY GmbH
Representative Office
2, Pshembaev Street
141200 Ekibastus
TPhone/Fax +7 71835 492 98
E-mail larisadvorak@mail.ru

SINGAPORE

INTERROLL (ASIA) PTE. LTD.
386 Jalan Ahmad Ibrahim
629156 Singapore
Phone:+65 6 266 6322
Fax: +65 6 266 6849
email: sgp-sales@interroll.com

THAILAND

RULMECA THAILAND Co. Ltd.
41/15 Moo 6, Bangchalong, Bangplee
Samutprakarn 10540 (Bangkok)
Phone:+66 2 337 0297
Fax: +66 2 337 0302, +66 2 337 0304
Email: th-sales@rulmeca.co.th

EUROPE

BELGIUM

UVO Technologies bvba
Rozenlei 37
B-2540 Hove Belgium
Phone: +32 3 4554322
Fax: +32 3 4543670
Mob: +32 479 820 655
email: michel@uvo.be

DENMARK

RULMECA A/S
Langebjergrvænget 19D
DK - 4000 Roskilde Denmark
Phone:+45 36 776755
Fax: +45 36 776855
email: dk@rulmeca.com

FINLAND, ESTONIA, LETLAND & LITAUEN RULMECA OY

Tuusantie 1 (2. krs),
03100 Nummela - Finland
Phone: +358 922435510
Fax: +358 922435100
E-mail msarjokoski@rulmeca.com

FRANCE PRÉCISMÉCA

Equipment de Manutention
Rue de La Gare
F-67700 Otterswiller
Phone:+33 3 88 71 58 00
Fax: +33 3 88 91 28 01
email: info.france@rulmeca.com

GERMANY

RULMECA Germany GmbH
Wilslebener Chaussee 12-14
D-06449 Aschersleben
Phone:+49 (0) 3473 956-0
Fax: +49 (0) 3473 956-210
email: faa@rulmeca.com

GREECE

TECOM KOUKOULIS LTD.
Ag. Nicolaou 60 16674 Glyfada - Greece
Phone: +30-2109604101 +30-2109604102
Fax: +30-2109604100
email: tecom@otenet.gr

ITALY

RULLI RULMECA S.p.A.
Via A. Toscanini, 1
I-24011 Almè (Bergamo)
Phone: +39 035 4300 111
Fax: +39 035 545 523
Web: www.rulmeca.it
E-mail: rulmeca@rulmeca.it

NEDERLAND

TRAMAT by
Vlietskade 7009 -
NL - 4241 WR Arkel
Phone:+31 0183 565 333
Fax:+31 0183 565 335
Web:www.Tramat.nl
email:info@Tramat.nl

NORWAY

INTERROLL A/S
Kobbervikdalen 65
N-3036 Drammen
Phone:+47 32 882600
Fax: +47 32 882610
email: n-sales@interroll.com

PORTUGAL

RULMECA DE PORTUGAL, LDA
P. Ind. do Tortosendo
Rua A Lote 15 Apartado 113
6200-823 TORTOSENDO
Phone:+351 275 330780
Fax: +351 275 330789
E-mail: rulmeca@rulmeca-interroll.pt

RUSSIA

RULMECA GERMANY GmbH
Büro Moskau: Leninskij Prospekt 95 A
117313 Moskau
Phone/Fax: +7 499 132 37 74
E-mail: faamsk@com2com.ru

SPAIN

RULMECA ESPAÑA S.L.
P.I. Urvasa C/Ripollés, 14
08130-Sta. Perpètua de la Mogoda - Spain
Phone:+34 93 544 9199
Fax: +34 93 574 4424
email: espana@rulmeca.com

SWEDEN

RULMECA A/S
Skaraborgsgatan 29A 53230
Skara Sweden
Phone: +46 511 160 27
Fax: +46 511 160 29
email: handersson@rulmeca.com

TURKEY

ROL-ER MAKINA SAN. VE. TIC. LTD. Sti.
Pembegul Sok. No. 12/10 Suadiye
34740 Kadikoy Istanbul Turkiye
Phone:+90-216-386 37 75
Fax: +90-216-386 38 22
Mob: +90 532 423 50 32
email: roler@superonline.com

UNITED KINGDOM RULMECA UK Ltd.

Brunei Road Earlstrees
Ind. Estate
GB-Corby, Northants NN17 4UX
Phone:+44 1536 748525
Fax: +44 1536 748535
email: uk@rulmeca.com

NORTH & SOUTH AMERICA

BRASIL

**TEC TOR INDUSTRIA E COMÉRCIO
DE EQUIPAMENTOS LTDA.**
Av. Novo Horizonte, 406
09060-820 - Santo André - SP
Brazil
Phone: +55 11 4428-2888
Fax +55 11 4421-9338
email: vendas@tector.com.br
Web: www.tector.com.br

CANADA

PRECISMECA LIMITED
606 - 19th Avenue
Nisku, Alberta T9E 7W1, Canada
Phone: +1 780 955 2733
Toll free: +1-800-661-4065
Fax: +1 780 955 9412
Web: www.precismeca.ab.ca
E-mail: sales@precismeca.ab.ca

USA

RULMECA Corporation
6508 Windmill Way, Suite B
Wilmington, NC
USA, 28405
Phone: +1-910-794-9294
Fax: +1-910-794-9296
Web: www.rulmecacorp.com
E-mail: mgawinski@rulmecacorp.com

VENEZUELA

INDUSTRIAS RULMECA S.A.
Zona Industrial Municipal Norte
Calle Este Oeste Galpón 67-200
Valencia, Edo. Carabobo, Venezuela
Phone: +58-241-833.62.49
+58-241-833.60.97
+58-241-833.61.12
Fax: +58-241-832.15.17
Web: www.rulmeca.com.ve
E-mail: rulmeca@cantv.net